



# GLENSIDE CAMPUS STUDENT ACCOMMODATION SITE INFORMATION

288 study bedrooms, 47 flats  
Blackberry Hill, Fishponds, Bristol, BS16 1DD

[uwe.ac.uk/accommodation](http://uwe.ac.uk/accommodation)

# Your flat and study bedroom

- Flats are organised into rooms for groups of between three to eight students.
- You'll share a kitchen, a living area and bathroom facilities.
- All accommodation is self-catering.
- All study bedrooms are single occupancy.
- Heating, electricity, water bills and ASK4 internet services are included as part of the rent.

## Kitchen/diner

Kitchen facilities include of a cooker, microwave, kettle and fridge/freezer. The number of facilities will depend on how many residents live in the flat. You'll need to bring your own cooking utensils. We recommend buying a toaster together as a flat once you have arrived. Communal areas also contain a dining table with chairs/stools. You are provided with a vacuum cleaner, ironing board, mop and mop bucket. You'll need to provide other cleaning materials yourself.

## Study bedroom

All study bedrooms have a single bed, wardrobe with hanging space, desk with chair, set of desk drawers, under bed storage, and bookshelves. The rooms are fully carpeted and curtained.

## Bathroom facilities

Each flat has a bathroom with either a bath and overhead shower attachment, or shower cubicle, hand basin and toilet. For flats of five or more students, there is also a separate shower room with shower cubicle and toilet.

## Heating

The flats have gas central heating. You can control the temperature in your study bedroom, during heating times, by adjusting the individual thermostat control on your radiator.

Heating times are regulated centrally by the University.

## Heating

Several buildings on Glenside are Grade II listed. This means that certain aspects are protected due to historical significance. As a result, the layouts of each flat and bedroom is unique to fit in with the existing structure.

## Example room layout

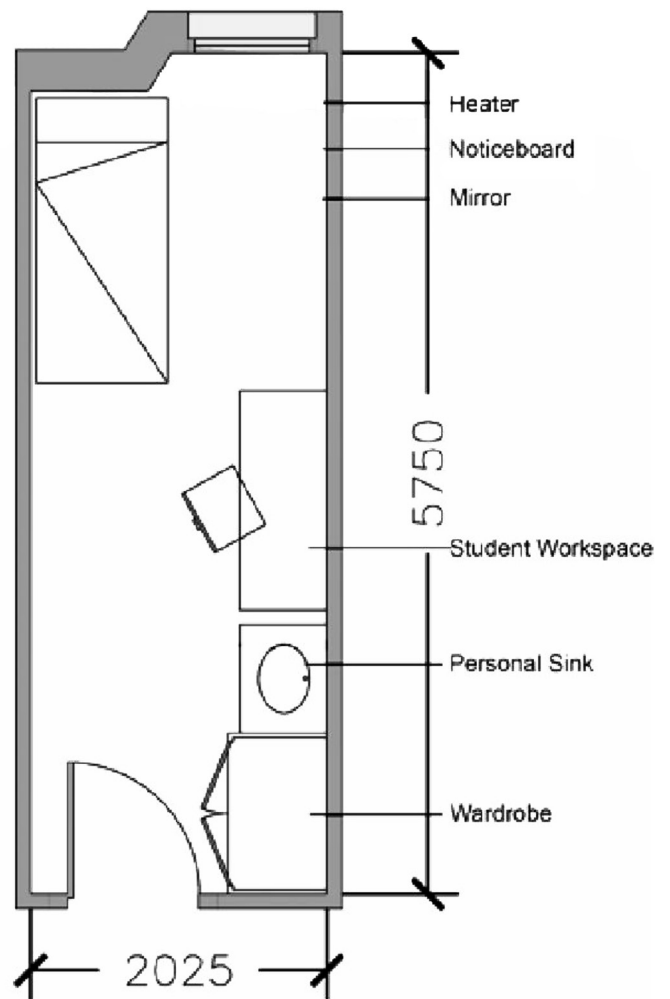

# Other facilities

## Laundry facilities

There is a laundrette on site, located by car park 4 and the Porters Lodge. Washing machines and tumble dryers are paid for via a mobile app.

## Car parking

There's a limited amount of student parking available in the main car parks on Glenside campus. Spaces aren't guaranteed and cars are left at your own risk. If you're planning to use one of these car parks, you'll need to apply for a parking permit via the MYUWE app. Please note there is no parking on Frenchay Campus for residents unless you are a blue badge holder.

We work closely with the council, police and local residents to ensure that students do not park in nearby residential areas, promoting good community relations with our neighbours. It is also a condition of your Licence to Occupy.

## Visitors parking

Visitors can park on Glenside Campus between 09:00–17:00 Monday to Friday. Limited visitor parking is available. Student's will need to contact [travel.team@uwe.ac.uk](mailto:travel.team@uwe.ac.uk) and [security@uwe.ac.uk](mailto:security@uwe.ac.uk) arrange visitor parking. Details of the visitor and their vehicle will need to be provided. Please see [uwe.ac.uk/parkingguidance](https://uwe.ac.uk/parkingguidance) for further information.

## Parking for motorbikes and mopeds

There's no designated parking on the Glenside Campus for motorbikes and mopeds.

## Bicycle storage

Residents with bikes can use the lockable on-site sheds. Please contact Customer Services to arrange access.

## Post and parcels

Post and parcels are delivered to Glenside residents. Make sure your address is correct and includes your student ID.

- Each flat has its own post box which is located in the corridor between car parks 4 and 5 to where Royal Mail will deliver letters.
- Post requiring a signature on delivery, parcels or items from couriers will be delivered to the Accommodation Customer Service Desk (1H29).
- Customer Services will email you once your parcel is ready for collection.
- You can collect your parcels from the Accommodation Office (1H29). See local information for opening times.
- The University cannot accept liability for any items of mail that fail to reach the addressee.

## Shopping

The Hub on Glenside campus serves hot food, sandwiches and drinks on term-time weekdays. Fishponds high street is a 20-minute walk from campus and has several supermarkets including Aldi, Lidl and Morrison's, banks and a variety of local shops and cafes.

There are frequent buses into the city centre. From there you can explore the vibrancy of Bristol. Student Life have created guides on what you can do: <https://studentlife.uwe.ac.uk/story/10666815/exploring-bristol-fishponds>

## Access and loss of keys

Access to Glenside accommodation is via a fob to enter the block doors and key for your flat and bedroom doors.

If you lose either the fob or key, Accommodation Services will replace this for you. For replacements, contact Customer Services. When you they are closed, please contact Campus Support either at the Porters Lodge (1H19) or call 0117 326 6404. They will provide temporary access. You will need to collect a permanent replacement key/fob from Customer Services when they're open.

To keep your home safe and secure, do not lend you keys to anyone or keep your keys with your address.

# Staff

## Customer Services

As well as the Customer Services desk in 1H29, there is also a desk on Frenchay campus in 2N02. They're Monday to Friday, 10:30-18:45, and 11:00-17:45 at weekends.

Tel: +44 (0)117 32 83601

Email: [accommodation@uwe.ac.uk](mailto:accommodation@uwe.ac.uk)

## Accommodation Managers

Accommodation Managers are available from 09:00-18:45 seven days a week to help you with day-to-day management of your accommodation. You can contact them via Customer Service, or email [accommodation@uwe.ac.uk](mailto:accommodation@uwe.ac.uk) for non-urgent matters.

## Campus Support Officers

Members of staff working throughout the evening and weekend, who are available to help with fire alarm activations, noise complaints and patrol the campus to keep you safe.

## Wellbeing

As well as on campus support, the Wisdom app provides UWE Bristol students with free access to 24/7 wellbeing counsellors and advice.

[www.uwe.ac.uk/life/health-and-wellbeing/get-wellbeing-support/student-support-247](https://www.uwe.ac.uk/life/health-and-wellbeing/get-wellbeing-support/student-support-247)



## Location – Glenside Campus

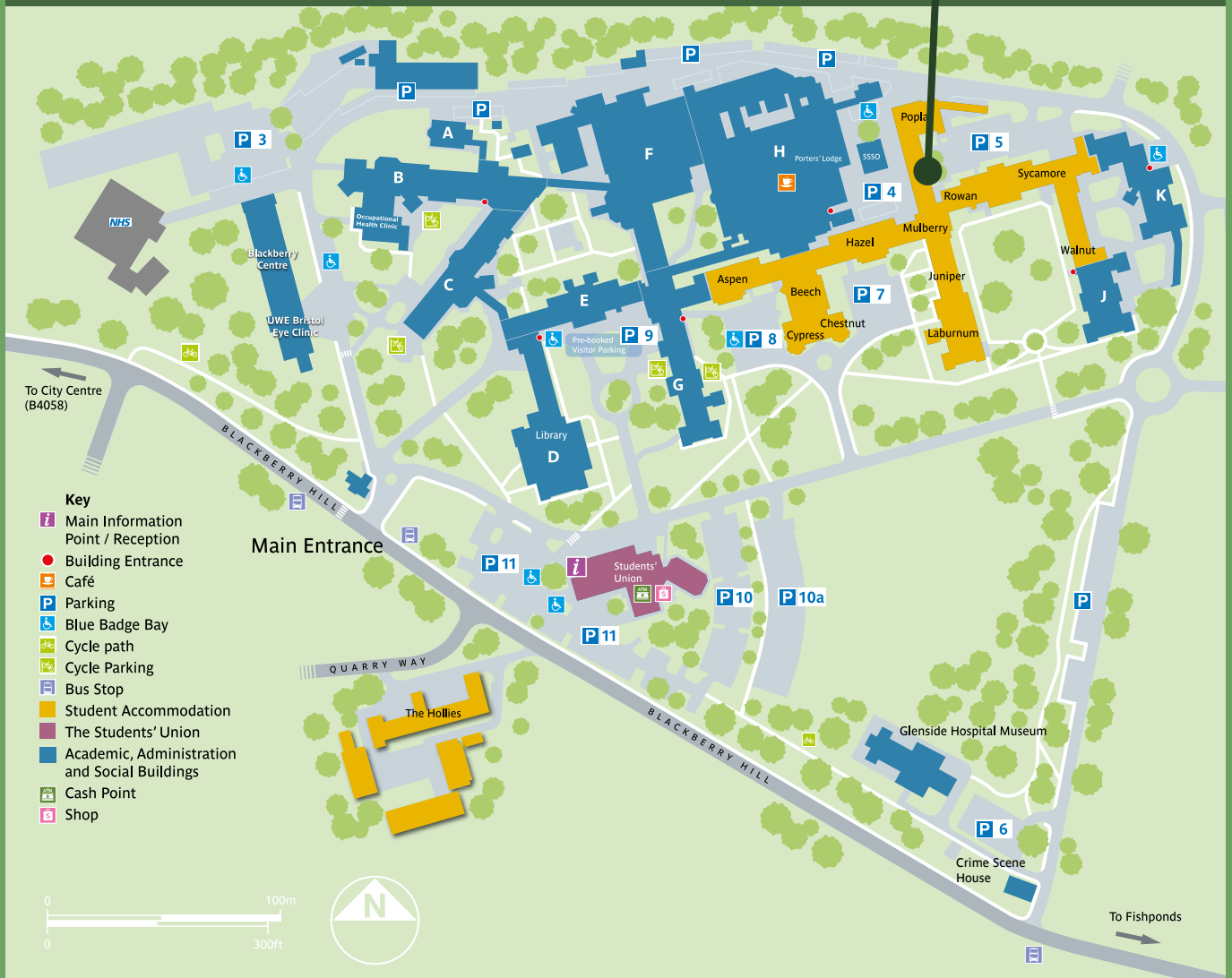

### Accommodation Services

University of the West of England  
 Frenchay Campus  
 Coldharbour Lane  
 Bristol BS16 1QY

[uwe.ac.uk/accommodation](http://uwe.ac.uk/accommodation)  
 Email: [accommodation@uwe.ac.uk](mailto:accommodation@uwe.ac.uk)  
 Telephone +44 (0)117 32 83601

