



STUDENT VILLAGE ACCOMMODATION SITE INFORMATION

1932 students/single study bedrooms, 326 flats

uwe.ac.uk/accommodation

Your accommodation

The Courtyards

The Student Village consists of four separate courtyards:

Brecon Court, BS16 1ZG	564 students
Cotswold Court, BS16 1ZH	500 students
Mendip Court, BS16 1ZL	400 students
Quantock Court, BS16 1ZP	468 students

Each courtyard has the following communal facilities:

- Post boxes (one per flat)
- Secure bicycle storage
- Common room (situated at Cotswold)
- Laundry facilities (situated at Brecon, Mendip and Quantock)
- Waste and recycling areas.

All accommodation can be accessed using a lift.

Your flat and study bedroom can be summarised as follows:

- Flats are organised in single rooms for groups of five or six students.
- Residents share an open kitchen and lounge area.
- All accommodation is self-catering.
- All study bedrooms are single occupancy.
- Gas, electricity, water bills and ASK4 internet services are included as part of the rent.

Kitchen and lounge area

Kitchen facilities for standard flats include two electric cookers, two fridge/freezers, kettle and microwave. You'll need to bring your own crockery, cutlery and cooking utensils.

The lounge area has a breakfast bar, stools, easy chairs, a sofa and coffee tables. There is a TV aerial socket within this area. You are also provided with a Hoover, ironing board, floor brush, mop and mop bucket. You'll need to provide other cleaning materials yourself.

Study bedroom

All individual study bedrooms have a single bed, wardrobe with hanging space and shelves, a mirror, a desk with chair, a chest of drawers, bedside table, desk lamp (or over desk lights) and bookshelves. The rooms are fully carpeted and curtained. There are TV aerial sockets in all bedrooms.

En suite bathroom facilities

Each study bedroom has its own en suite wet room complete with a shower, toilet and wash basin.



Heating

The Student Village heating system is supplied by Prefect and consists of an Iris Controller unit which enables residents to control the temperature and set it to their desired heating level. The unit also has a sensor which detects changes in temperature, whether a room is empty or a window has been opened.

For further information about how to use your heater please see the following user guide: browser.co.uk/uwe/how-to-use-your-student-village-heater_97681

Typical room layout

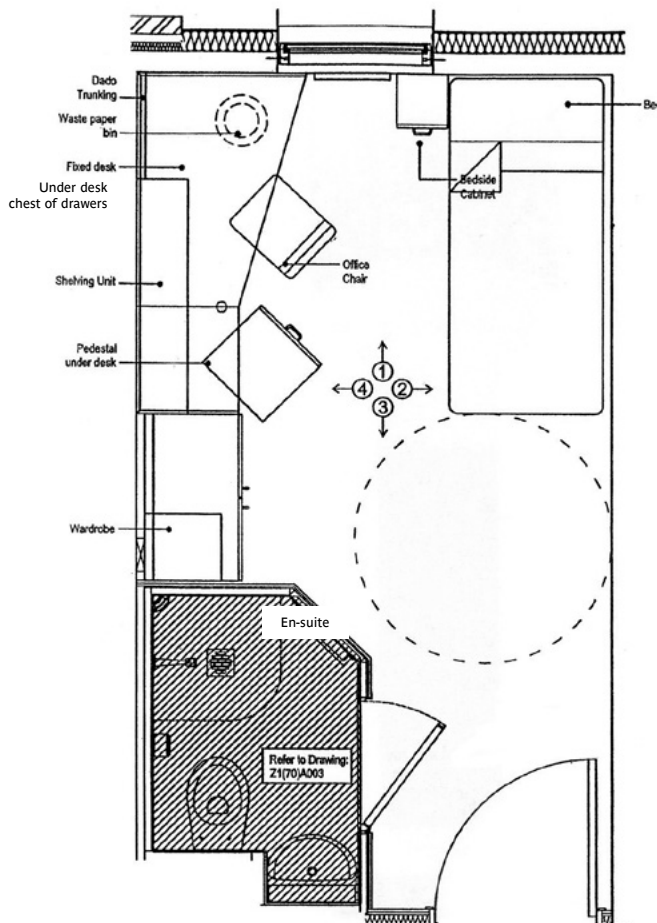

Other facilities

Laundry facilities

You have access to three laundry facilities in Brecon, Quantock and Mendip Pavilions.

This facility is operated with the use of a mobile app or laundry card if residents don't have a smart phone. See local signage for costs.

Car parking

There are no car parking facilities on campus for residents unless you are a blue badge holder. We work closely with the council, police and local residents to ensure that students do not park in nearby residential areas, promoting good community relations with our neighbours. It is also a condition of your Licence to Occupy.

Visitors parking

Visitor parking on campus is limited during the University's core hours (Monday–Friday 09:00–17:00). Your visitors should contact travel.team@uwe.ac.uk for guidance prior to their visit. uwe.ac.uk/parkingguidance

Parking for motorbikes and mopeds

There is designated parking on campus for motorbikes and mopeds in car parks 3, 4 and 15, accessible at Northavon House via the North entrance on Frenchay Campus. No permit is required.

Bicycle storage

There is lockable covered bike storage within the Student Village – please contact Customer Services for access. Bikes must not be stored inside the flats. We recommend the use of a good quality bicycle lock.

Mail

Please ensure that all mail is properly addressed to include your Flat and Courtyard number. It is helpful to add your student ID number after your name.

- Each flat has its own post box situated in the appropriate courtyard pavillion.
- If you are not at home, post requiring a signature on delivery will be delivered to Customer Services and can be collected (within opening hours) after you have been sent an email to advise it is ready. See local information for opening times.
- Please do not sign for other people's mail – it should only be collected by the addressee.
- It is an offence to open other people's mail.
- The University cannot accept liability for any items of mail that fail to reach the addressee.

Shopping

There is a convenience store on Frenchay Campus in The Students' Union. It sells essentials like milk and toiletries as well as drinks, snacks and stationery. There are also several cash points and a fresh fruit and veg stall on campus.

Within walking distance of Frenchay Campus there's a retail park (Abbey Wood Shopping Park) and three supermarkets – ASDA, Lidl and Sainsbury's. Please don't bring shopping trolleys onto campus.

There are frequent bus services to the City Centre and The Mall at Cribbs Causeway, a large out-of-town shopping centre.

Access and loss of key cards

Access to the Student Village is via an access card which opens the courtyard pavilion doors as well as your block door, front door and bedroom door. If you lose your card we will provide a replacement for a small fee. Replacement cards can be obtained at Customer Services.

Please do not keep your property address with your card as this is a potential security risk. Please do not lend your card to anyone and report lost/stolen cards immediately to Customer Services. Staff will be able to issue you with a replacement access card. When Customer Services is closed, East Reception will issue a temporary access card and you will need to go to Customer Services the following day for a permanent replacement.

Staff

Customer Services

Customer Services is open daily between 07:00–19:00 and is located in 2N02 on Frenchay Campus, (next to OneZone). For assistance please drop in, phone **+44 (0)117 32 83601** (option 1) or email accommodation@uwe.ac.uk

Accommodation Managers

Accommodation Managers are available from 08:00–19:00 seven days a week to help you with day-to-day management of your accommodation. You can contact them via Customer Services or email accommodation@uwe.ac.uk for non-urgent matters.

Campus Support Officers (CSOs)

Members of staff working throughout the evening and weekend, who are available to help with fire alarm activations, noise complaints and patrol the campus to keep you safe.

Out of Hours Team

For support between 19:00–07:00 and at weekends please call 07814 791212. For further information see: uwe.ac.uk/life/health-and-wellbeing/get-wellbeing-support/out-of-hours-team



Location – Frenchay Campus



Accommodation Services

University of the West of England
 Frenchay Campus
 Coldharbour Lane
 Bristol BS16 1QY

uwe.ac.uk/accommodation

Email: accommodation@uwe.ac.uk

Telephone +44 (0)117 32 83601

